



Industrial  
Automation  
since 1991

PENTA®

PENTA  
US INC.





PENTAAUTOMAZIONI INDUSTRIALI S.R.L.

ITALY

[mail@penta-automazioni.it](mailto:mail@penta-automazioni.it)

Phone: +39 051 882880 / +39 051 880550

Via Aldo Moro, 32 - 40062 Molinella (BO)

Web: [www.penta-automazioni.it](http://www.penta-automazioni.it)



PENTA US INC.

U.S.A.

[mail@pentaus.us](mailto:mail@pentaus.us)

Phone: +1 (470) 3504777

509 Madison Avenue, Suite 1510

NY 10022

Web: [www.pentaus.us](http://www.pentaus.us)



Penta Automazioni Industriali S.r.l.



# COMPANY



Penta Automazioni Industriali S.r.l. was **founded in 1991** by the President Mr. Selvino Simoni with the aim of offering solutions to automate the production of paper, aluminum, ceramics, natural stone and concrete products. At the beginning, our business embraced five different manufacturing sectors (hence the name “Penta”, from the ancient Greek word meaning “five”) but later we have specialized on concrete and natural stone industry needs, and this has become our field of activity.

Nowadays the company is a leading equipment manufacturer based in Italy, highly **specialized in the concrete and natural stone industry**, with plants running all over the world.

Starting from a small production company located in Molinella, in the province of Bologna, we have extended our network worldwide, thanks to our constant commitment to use high quality products and our **ability to provide individual solutions** and services for concrete and natural stone industry.

From the beginning we have focused on the **extreme flexibility of our plants**. Every plant has been designed and built according to the **different needs of each customer**, like a **tailor-made suit**. That's why every installation is a unique example.

The flexibility of our handling, secondary processes, stacking and packaging plants for concrete and natural stone products is completed by a wide range of customized services that enable us to follow our customers before, during and after the installation of the required plant.

The mechanical, electrical and software realization are carried out in-house by our engineers and skilled technicians.

This has always been the lead value and the key to success for Penta, and in this way we have gained the pleasure and trust of all our customers.

Built in our factory in Molinella, our systems represent the **true essence of “Made in Italy”**: unique design and high quality, attention to detail, innovation in connection with tradition.



# PENTA US INC.



*Penta thus strengthens its presence and its activities in the United States with the ambition of assist more and more customers.*

*Penta will be able to do that thanks to the newly established **Penta Us Inc.**, based in New York City, and to the new domestically located spare parts warehouse, **Swift River Machine Inc.***





## *Vision and Mission*

---

*"Think outside the box" is our value.*

# VISION and MISSION

## Our vision

*Our goal is to become worldwide leaders of concrete and natural stone industrial automation through the customization of the solutions we offer.*

## Our mission

*Our mission is to provide customized technical solutions tailored to customers specific needs:*

- *By increasing our range of services and products in order to develop innovative and highly personalized solutions from handling, to aging, to secondary processes installations;*
- *By confronting enthusiastically every new challenge to get the highest satisfaction from our customers;*
- *By investing in quality, safety and customer care;*
- *By consolidating our presence in Italy, Europe and all over the world;*
- *By creating a safe and stimulating work environment where the qualities and skills of each employee are valued as a mean of growing together every day.*



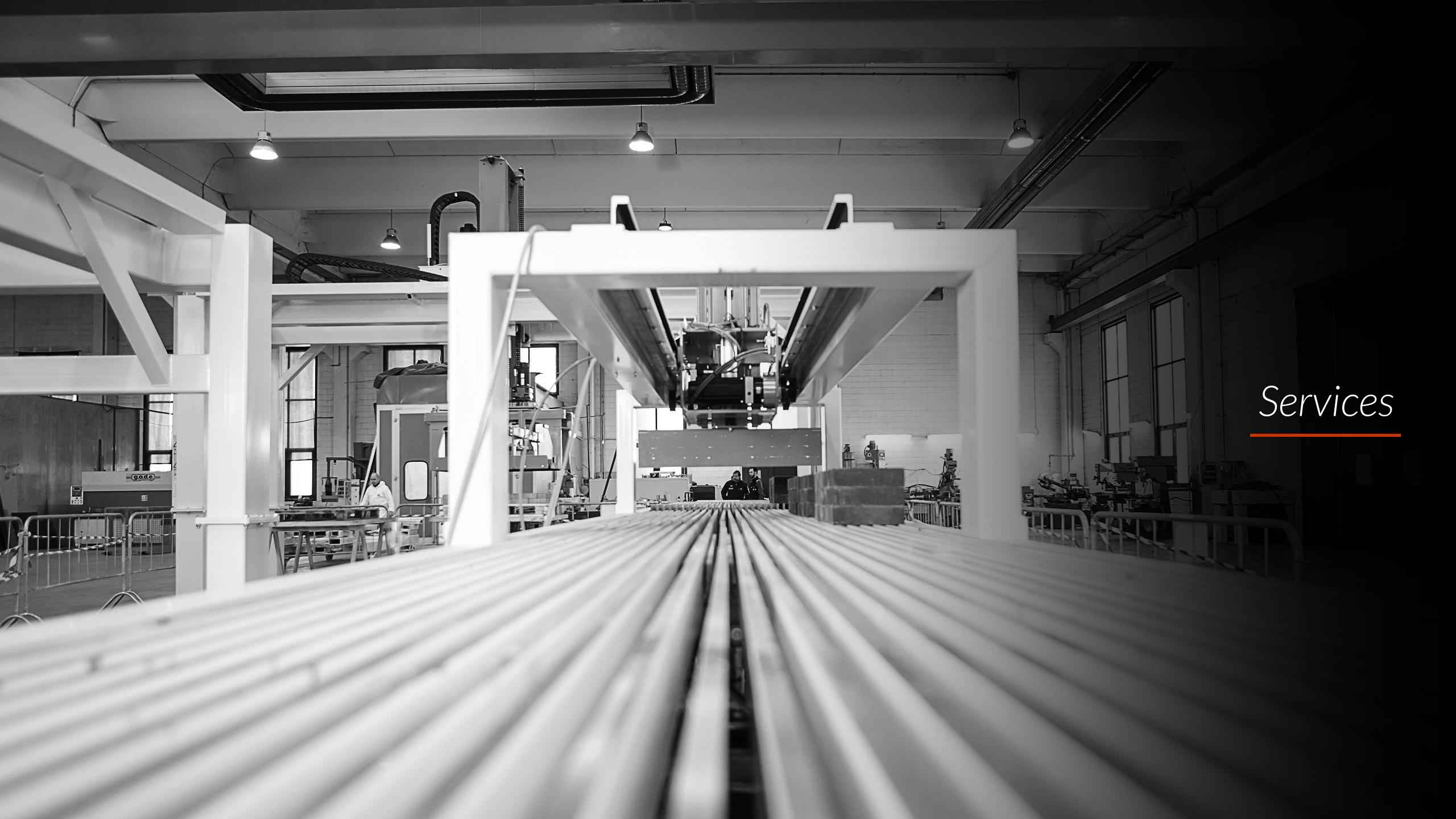

*Services*

---



## *Pre-sales and installation*

# Services

*At your service since 1991*

### Consultation

*We will visit your factory to study, research and design the machines to find the best solution according to your production, aging, splitting, handling needs and spaces available and we will modify and adjust the project until your expectations have been achieved.*

### Pre-assembling

*We will assemble, pre-wire and test your plant at Penta's, in order to verify and control its functioning before the shipment. This will allow to reduce the duration of the installation at your site.*

### Assembling and commissioning

*Once your plant has been tested at Penta's, we will dismantle and load it on suitable means of transport. When it arrives at your building our skilled and qualified technicians will carry out the installation and the commissioning. duration of the installation at your site.*

### Software

*Each plant's software is designed in-house by our software technicians considering the needs and requests of the customer, so our plants are intuitive and easy to use.*

### Training of your technicians

*From the very beginning of the installation and commissioning your technicians will join our qualified team and will be trained to work with the machine in full autonomy.*



# Services

*At your service since 1991*

## Maintenance

*A proper maintenance is fundamental for the safety of your staff and for the efficiency of your plant. Penta also makes available routine and extraordinary maintenance service to its plants. Trust Penta to take care of your plant and plan its mechanical and electrical maintenance and the software upgrade in order to keep the plant up-to-date.*

## Remote Assistance and On-Site Support

*Our technicians are at your disposal to plan and carry out interventions for software updates, tuning and modifications of your system functions both at your site and by internet connection. Our technicians are always available also to assist you and to solve any possible anomaly or error of your plant. Plants are intuitive and easy to use.*

## Retrofit

*We can study your existing plants to analyse where we should operate and where we should adjust or add some new equipments in order to extend the life of your installation.*

## Spare parts

*We know that spare parts are necessary to maintain plant always efficient and performing and having a kit of them always available prevent from downtime in the production. For this reason Penta provides its customers quickly and efficiently with the spare parts they need.*



After sales



*Products overview*

---



You can envision it. We can design and build it.

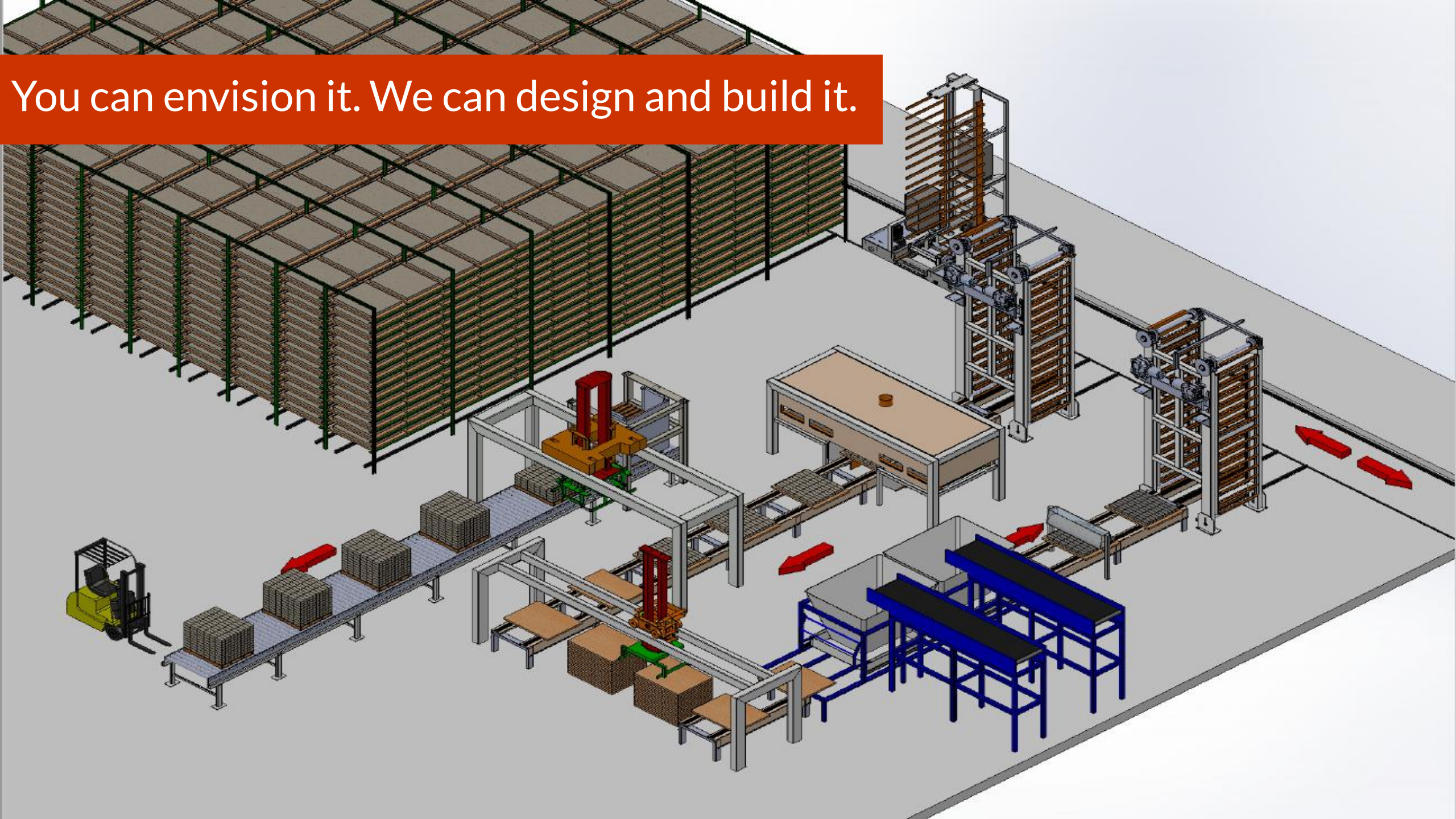



# Handling Production Plant

- Automatic Handling System
- Tailor-made Solutions
- Efficiency
- Improving Production

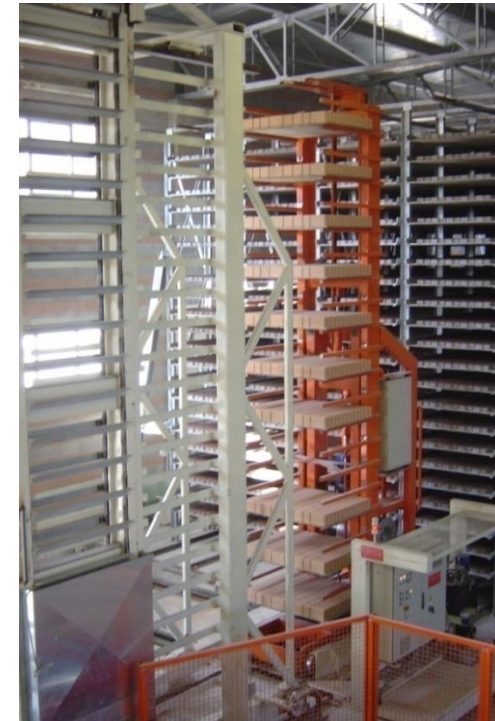
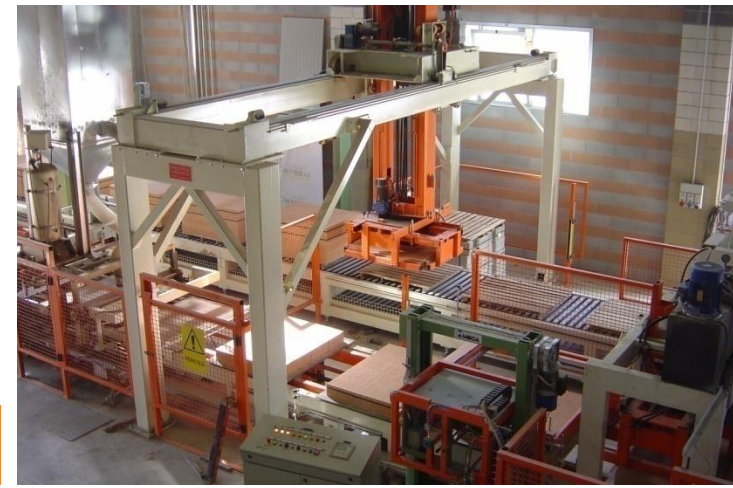

TRANSFER CAR





*Wet side*



*Dry side*





## Dry side

Dry products can be transferred to the gripper or to secondary treatments machines.

This line can be completed with some optionals:

- materials quality control
- squeezer and doubler materials layer
- cleaning system for boards (according to the kind of boards)
- packaging system for single layers



## Wet side

This line is designed to move wet products in a safe way in order not to lose quality during the transfer to the elevator.

This line can be completed with some optionals:

- brush for cleaning products
- washing system/machine
- tilting device / push off device
- quality control (weight and height control)

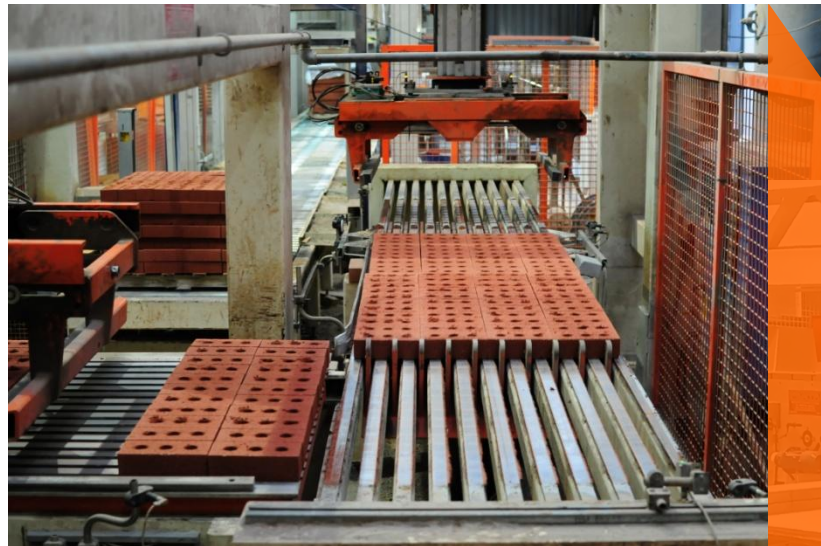



# Handling Specialized Products

Penta can offer its customers the full range of machines for handling

## GRIPPERS

### VACUUM GRIPPER

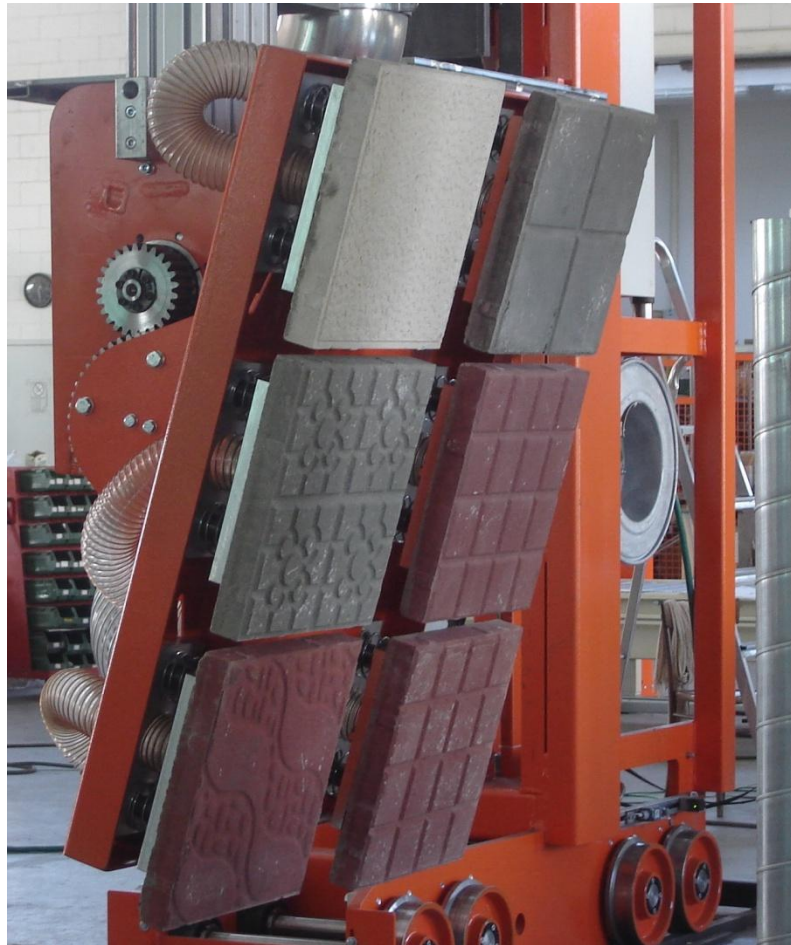

- *It can manage both blocks and slabs*
- *Versatility*
- *Rapidity*
- *Flexibility*
- *Aspiration system*



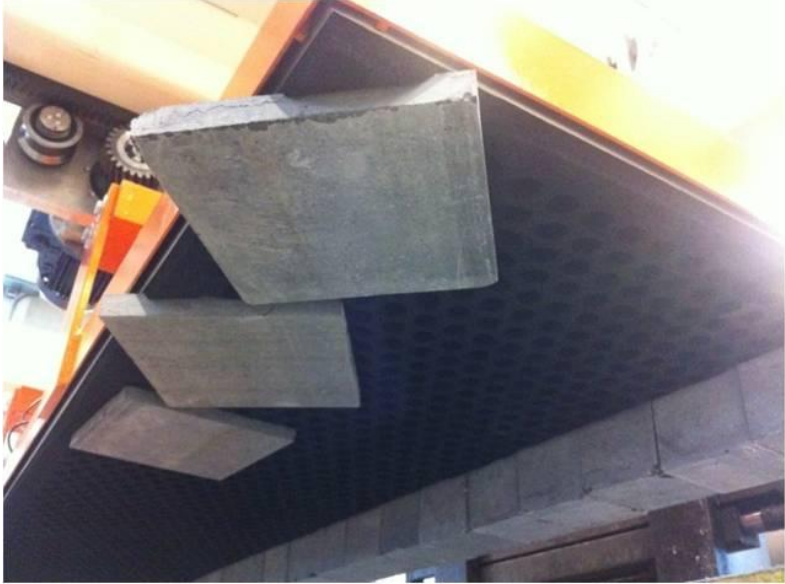



## CUSTOM - MADE HANDLING SOLUTIONS

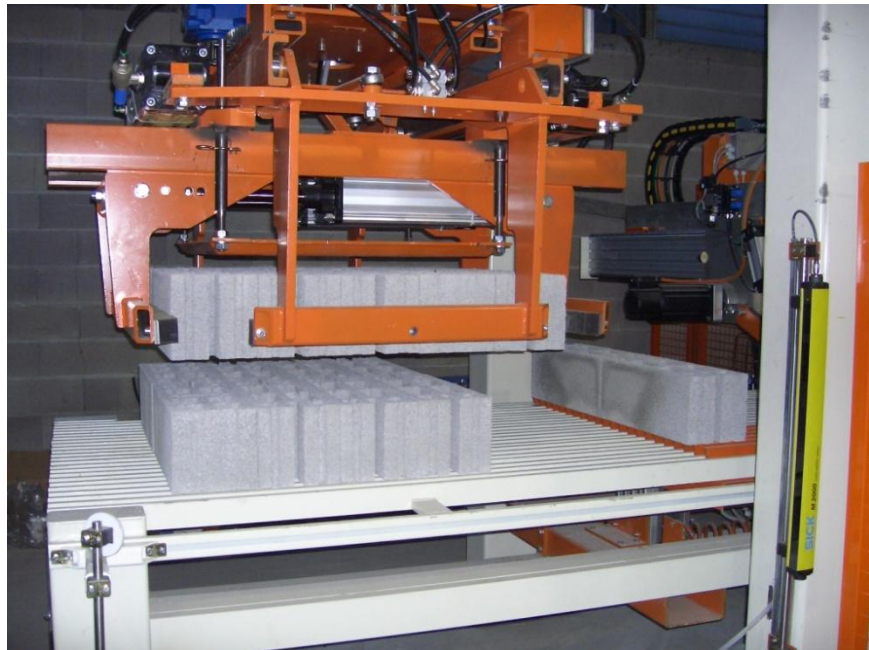
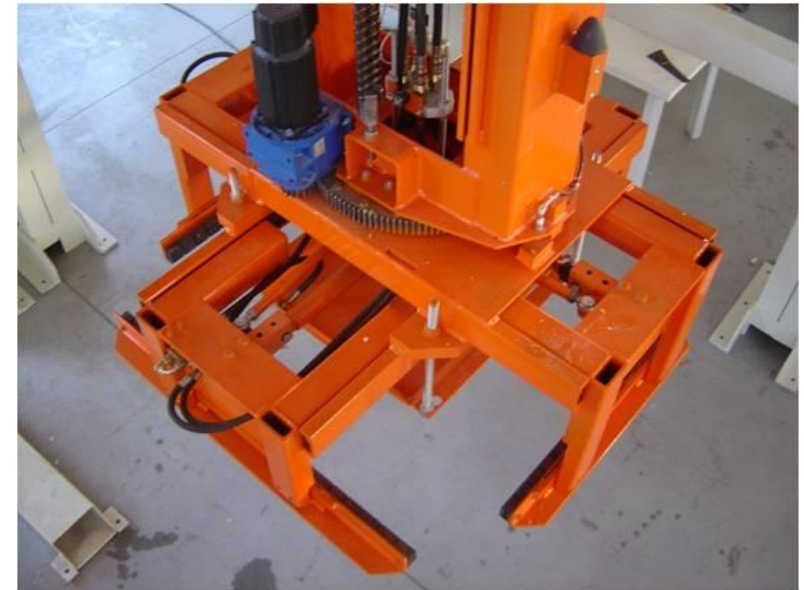

We can supply any kind of grippers:

- ✓ Electric grippers
- ✓ Vacuum grippers
- ✓ Pneumatic grippers
- ✓ Hydraulic grippers



# ROBOTS



- Robot integration
- One or more pick up head/s
- Different calibration according to the materials to be managed
- Precision, liability and flexibility
- It can manage any kind of product (pipes, ceramic tiles, big slabs, small blocks and pavers, etc.)





Handling Ceramics Slabs



Plant for platform



Custom Made Plants

Robot



Handling Barbecue Plant



Handling slabs





## TURN-KEY SOLUTIONS

Penta is glad to offer its customers turn-key plants and we will look after all the steps from the design up to the commissioning mechanical, electrical and software design, through the mounting and commissioning up to the after-sales services.

## INSTALLATION AND SAFETY

Penta pays attention especially for the safety of its plants and provides all the safety equipments needed to protect the plant and to avoid any risks for the technicians in charge.

Just after the installation and start up of all the safety equipments, Penta staff can start up the entire plant. All Penta installations comply with applicable regulations and legislations for the different Countries.

### **Penta Automazioni Industriali S.r.l. Italy**

Via Aldo Moro, 32  
40062 Molinella (BO) Italy

Phone  
+39 051 880 550

Fax  
+39 051 881 386

[www.penta-automazioni.it](http://www.penta-automazioni.it)  
[sales@penta-automazioni.it](mailto:sales@penta-automazioni.it)

### **Penta U.S. New York**

509 Madison Avenue,  
Suite 1510  
NY 10022

Phone  
+1 (470) 350 4777

[www.pentaus.us](http://www.pentaus.us)  
[mail@pentaus.us](mailto:mail@pentaus.us)

For further information please visit:

[www.penta-automazioni.it](http://www.penta-automazioni.it)   [www.pentaus.us](http://www.pentaus.us)

